

Leuven Gierzwaluwenstad

De Ferri-steenzwaluw

A black bird, likely a swallow, is captured in flight over a red-tiled roof. The bird is positioned in the lower right quadrant of the frame, with its wings spread and its tail feathers visible. The background is a blurred view of a cityscape, showing a dark blue roof with several orange-tiled chimneys and a white building facade. The overall scene is set against a clear blue sky.

Foto: Dominique Arnhem

Gierzwaluwen

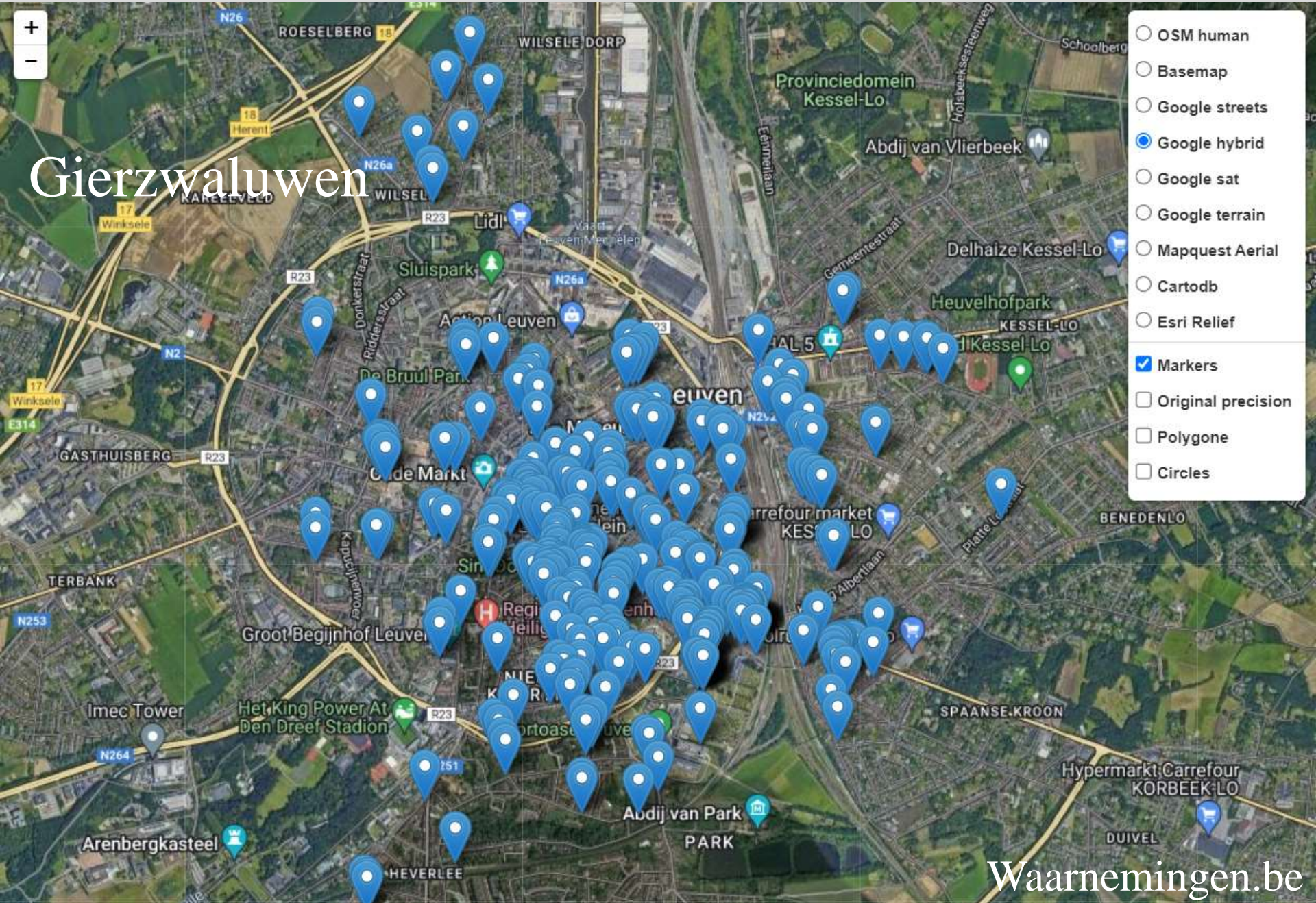

Inventarisatie sinds 2001



2/3





























Wat zijn stelling- of steigergaten?



Siena, Ambrogio Lorenzetti 1337-1340

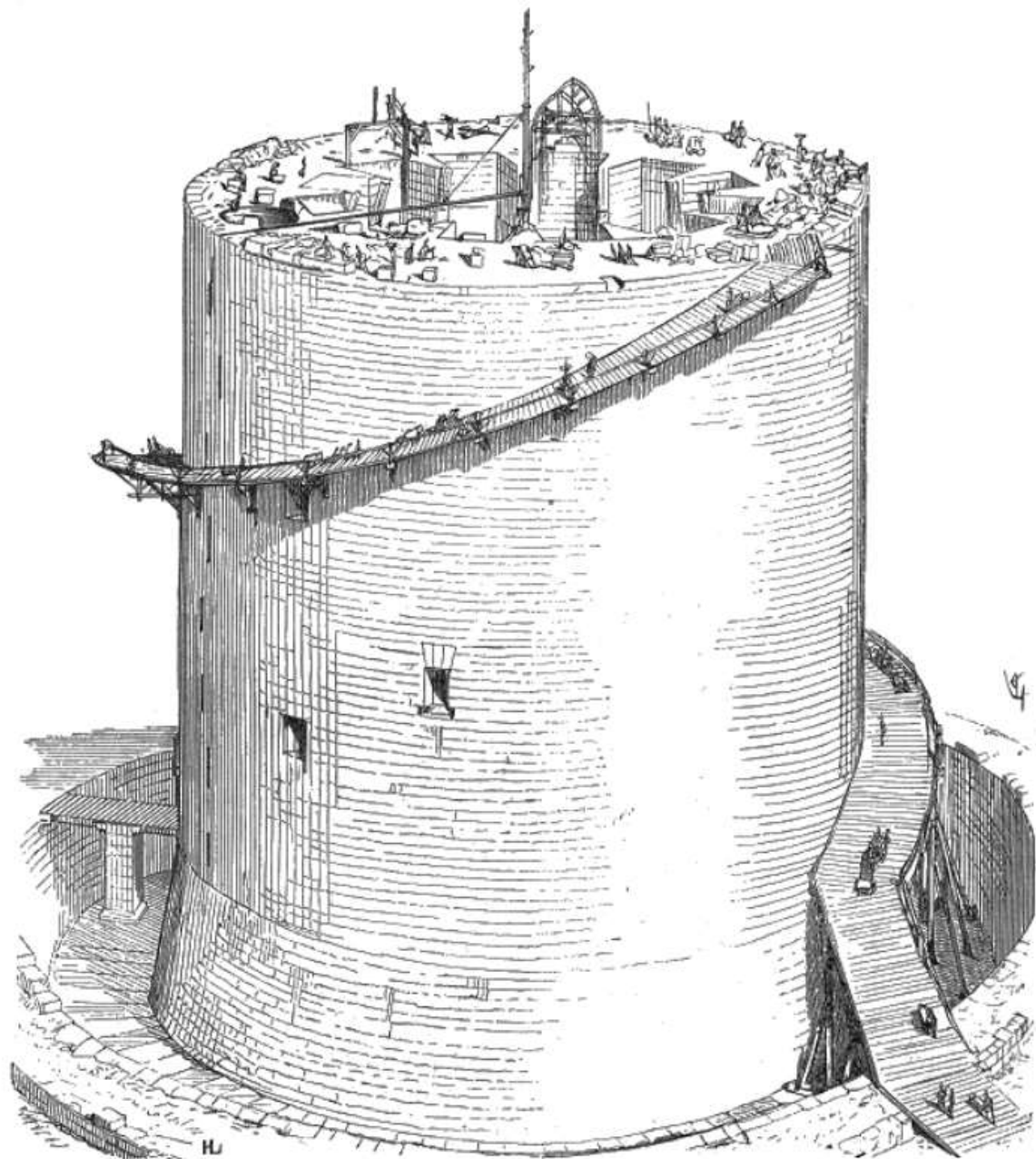







Château du Guédélon





Mauro Ferri



























Willy Ceulemans



9,9 miljard per jaar aan renovatie- en herstellingswerken

Dominique Arnhem



Google

Google Earth



2023



Veteranorumcollege KULeuven

2008

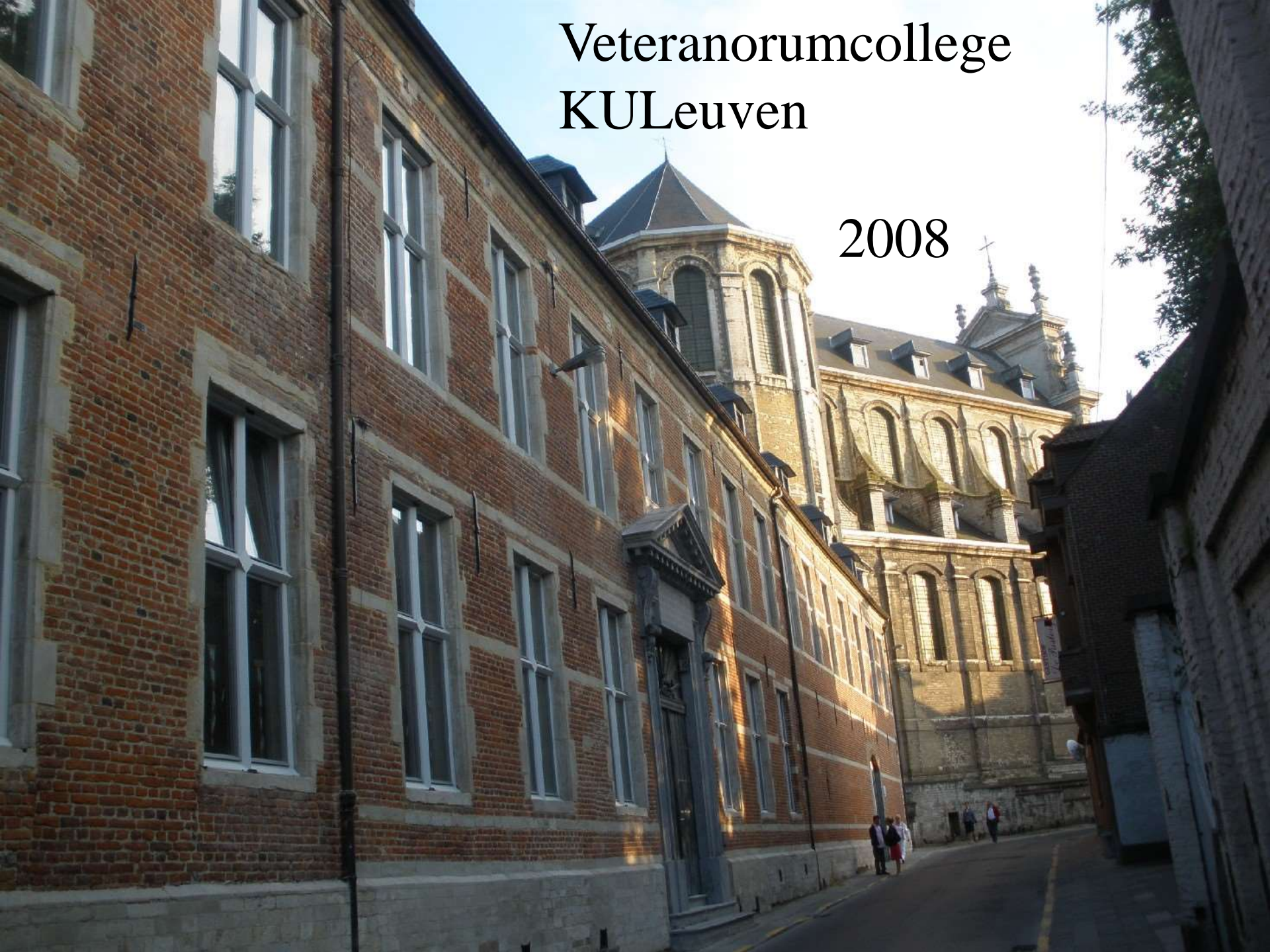



KATHOLIEKE UNIVERSITEIT
LEUVEN

Figuur 5: Architecturale ontwerp van een steigergat.
 (Zeljka Knezevic, Monumenten KULeuven)

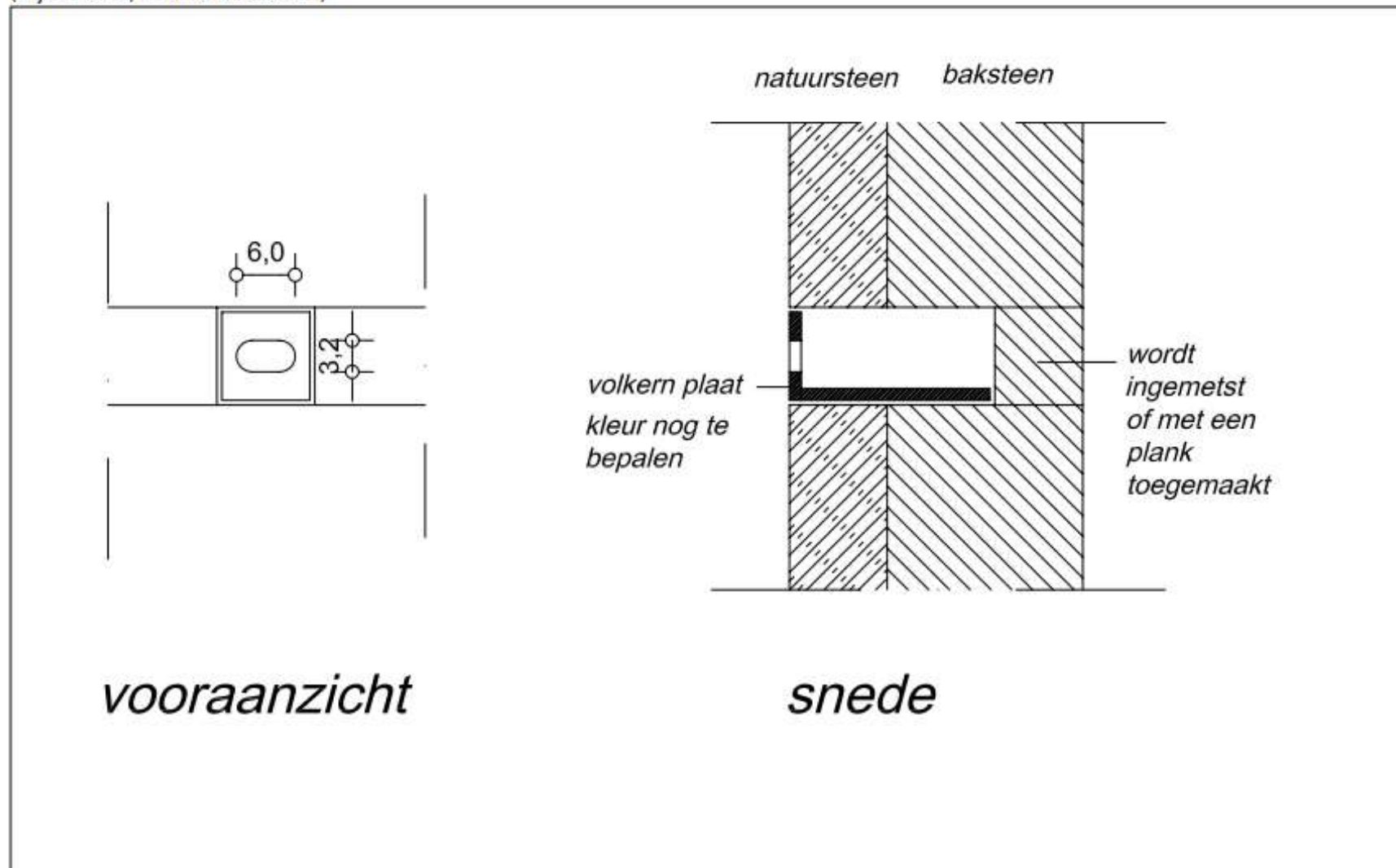

Technische Diensten K.U. Leuven
 Divisie : Monumenten
 Afdeling :
 Willem de Croylaan 56
 3001 Heverlee

Gebouw nr. : 109-20
 Naam : Veteranorum
 Straat : St. Michielsstraat 2
 Plaats : Leuven

Verdiep :
 Lokaal :
 Tekenaar : KNZ
 Datum : 03/06/08

Werknummer : W 6891

Bestandsnaam :

Steigeraten met
 openingen voor gierzwaluwen

Blad	1/1
Schaal	1/5



Maria-Theresiacollege

Veteranorumcollege







GASTHOF
De Pastorij

Agora KULeuven







108 nieuwe gaten

A photograph of a brick courtyard. The walls are made of red brick with horizontal bands of light-colored stone or concrete. At the top, there is a balcony with a brick railing featuring several arched openings. Two black downspouts run vertically down the walls. In the center, there is a structure with a grey, gabled roof. At the bottom, there are windows with light-colored frames. The text "30-tal bezocht / beslapen of bezet" is overlaid in white in the center of the image.

30-tal bezocht / beslapen of bezet

Pauscollege KULeuven



Grootste historische kolonie Leuven

117 stellinggaten



A square wooden door is set into a rough, textured wall. The door has two circular holes, one near the top and one near the bottom. The wall is made of a mix of grey and brown material, possibly concrete or stone, with some white residue on the left side. The door is slightly recessed into the wall.

Ongeveer 30 bezette nesten

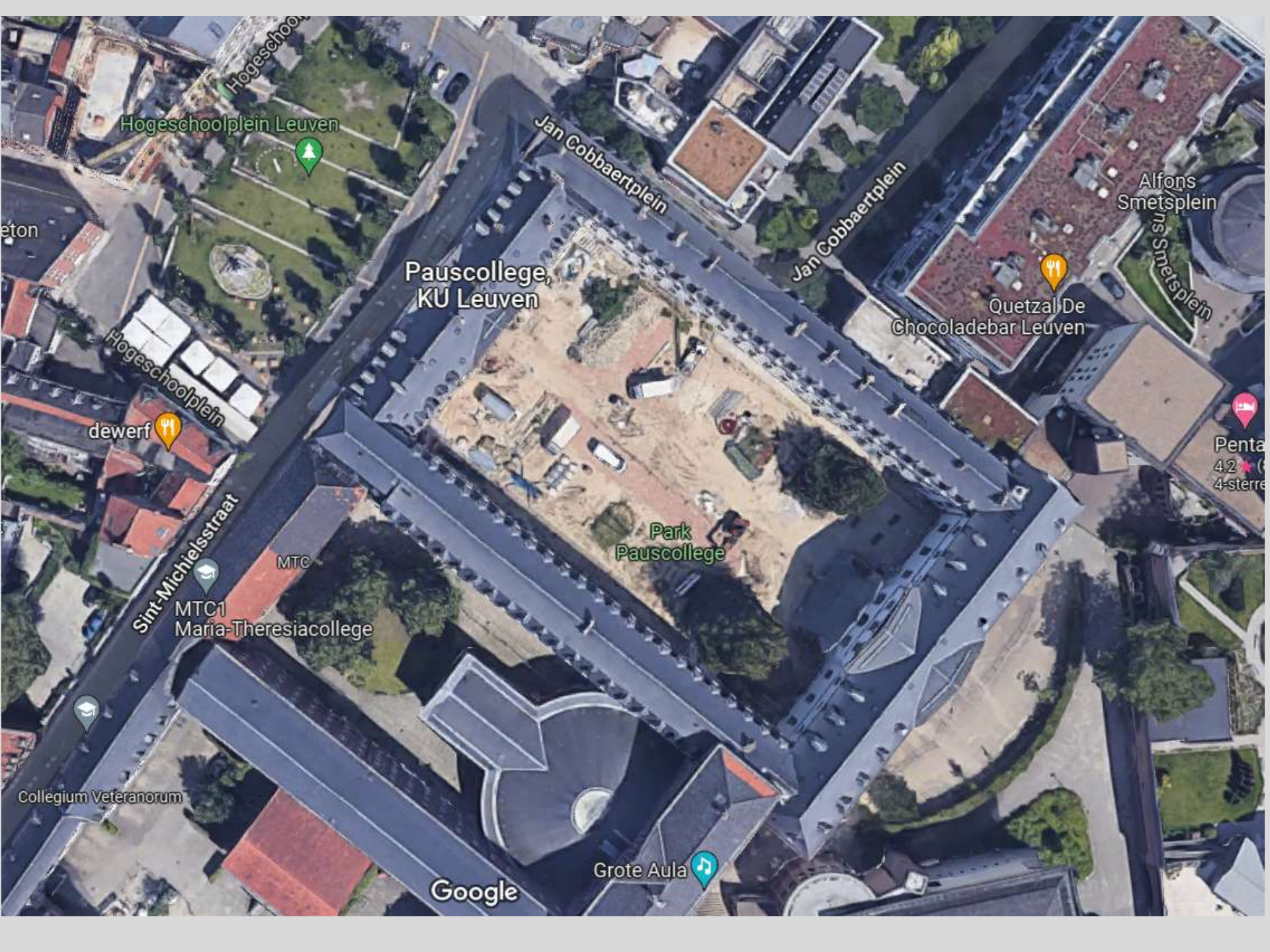

Hogeschoolplein Leuven

Hogeschool

Jan Cobbaertplein

Jan Cobbaertplein

Alfons Smetsplein

Alfons Smetsplein

Pauscollege, KU Leuven

Quetzal De Chocolatebar Leuven

Hogeschoolplein

dewerf

Penta 4.2 (4-sterre)

Park Pauscollege

Sint-Michielsstraat

MTC

MTC1 Maria-Theresiacollege

Collegium Veteranorum

Grote Aula

Google

BUCHE PONTAIE SELETTIVE PER FAVORIRE I RONDONI ED ESCLUDERE I COLOMBI DALLA GHIRLANDINA

M. Ferri¹, M. Ferraresi¹, A. Gelati¹, R. Cadignani², G. Rossi³, U. Tigges⁴

¹AUSL, Servizio Veterinario, Modena, ²Servizio Edifici Storici, Comune di Modena,
³AsOER (Ass. Ornitologi Emilia Romagna), ⁴Common Swift-APUSlife

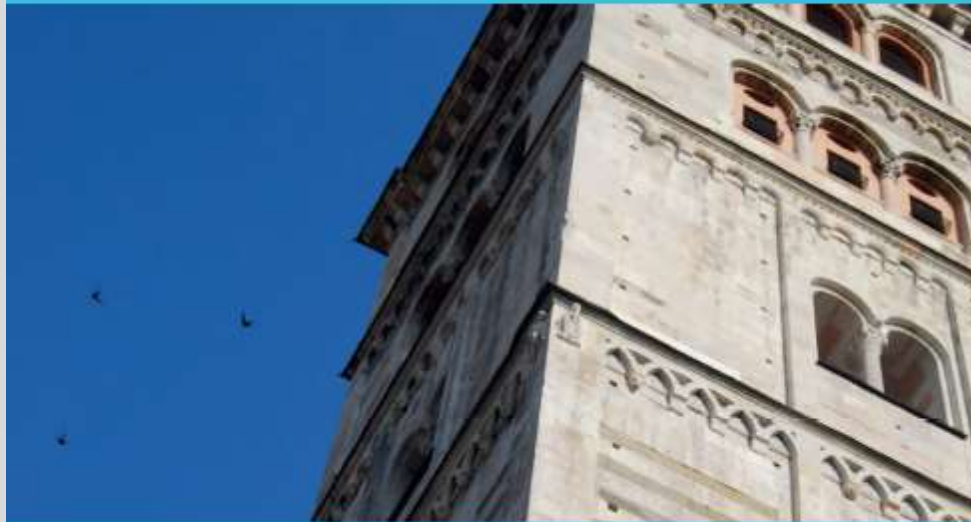

4. 5 luglio 2013: un gruppetto di rondoni subadulti in volo attorno alle buche che ospitano le coppie nidificanti

Mauro Ferri

**SELECTIVE EXCLUSION OF
PIGEONS FROM
SCAFFOLD HOLES**

Mauro Ferri

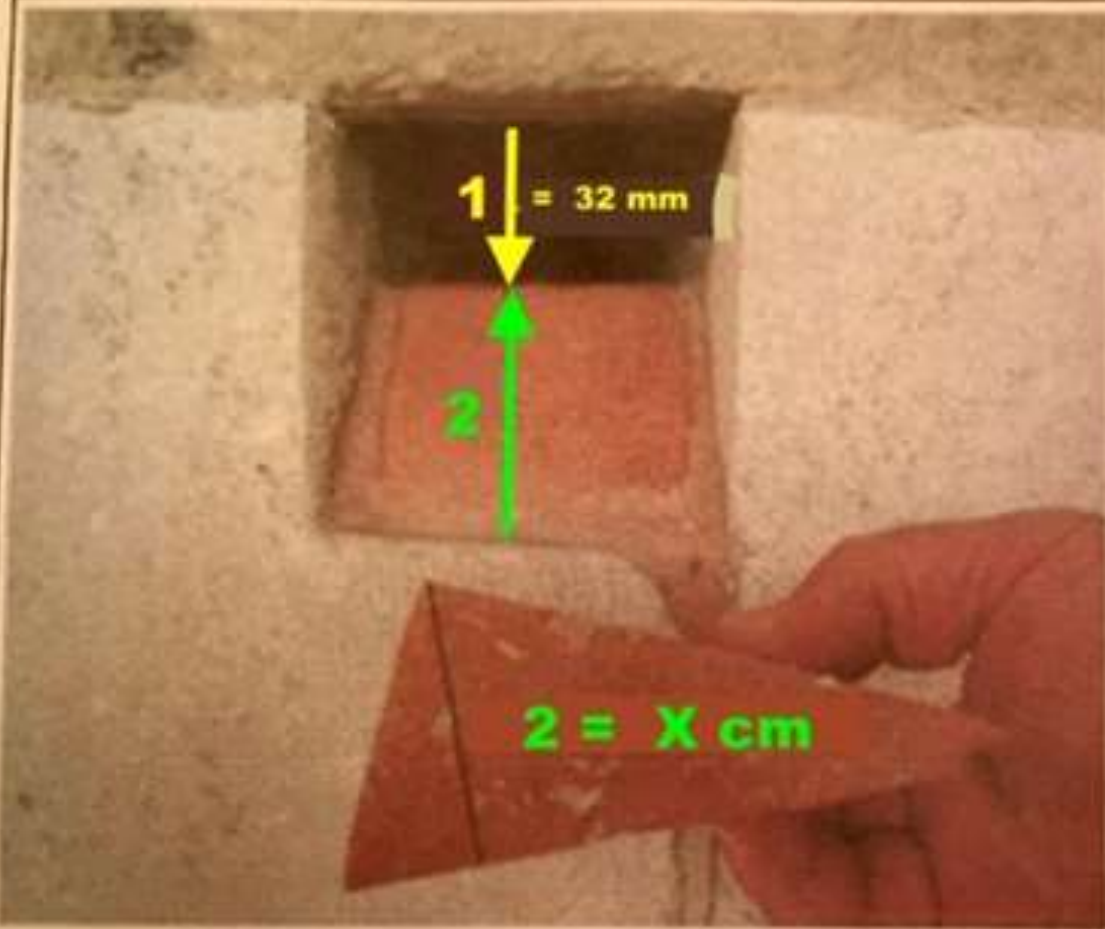

Bewerkt door Johan Kempeneers

be sure that this plan has an inclination of $> 45^\circ$ to prevent pigeons from using it as a support for nesting or roosting

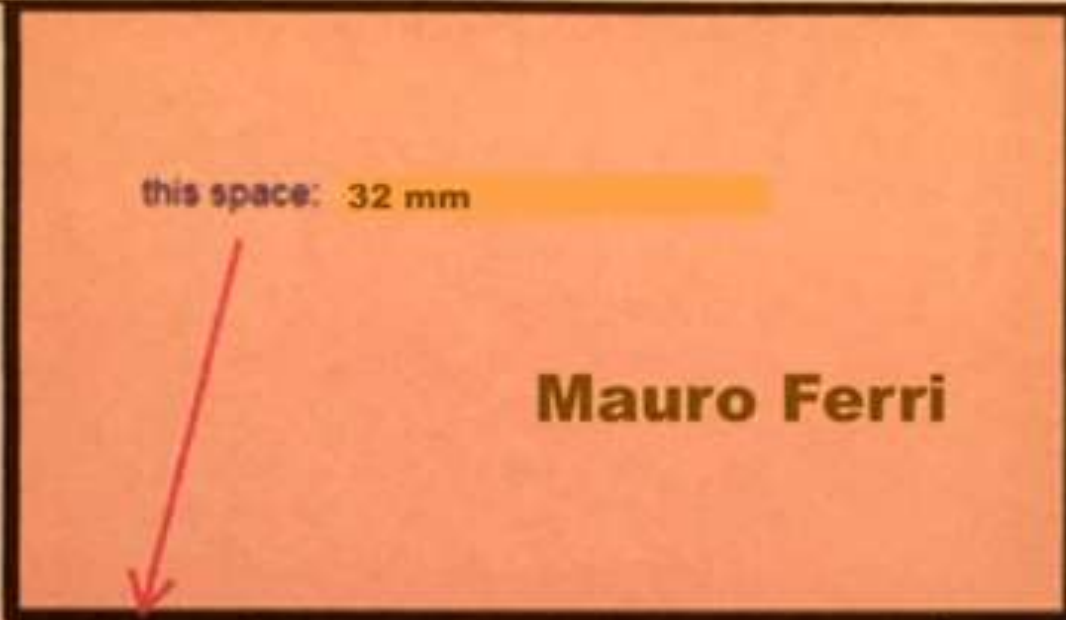

this space: 32 mm

Mauro Ferri

OUTSIDE

INSIDE

plug

32 mm

!!! →

this plan is better have a low inclination $< 45^\circ$



Bewerkt door Johan Kempeneers

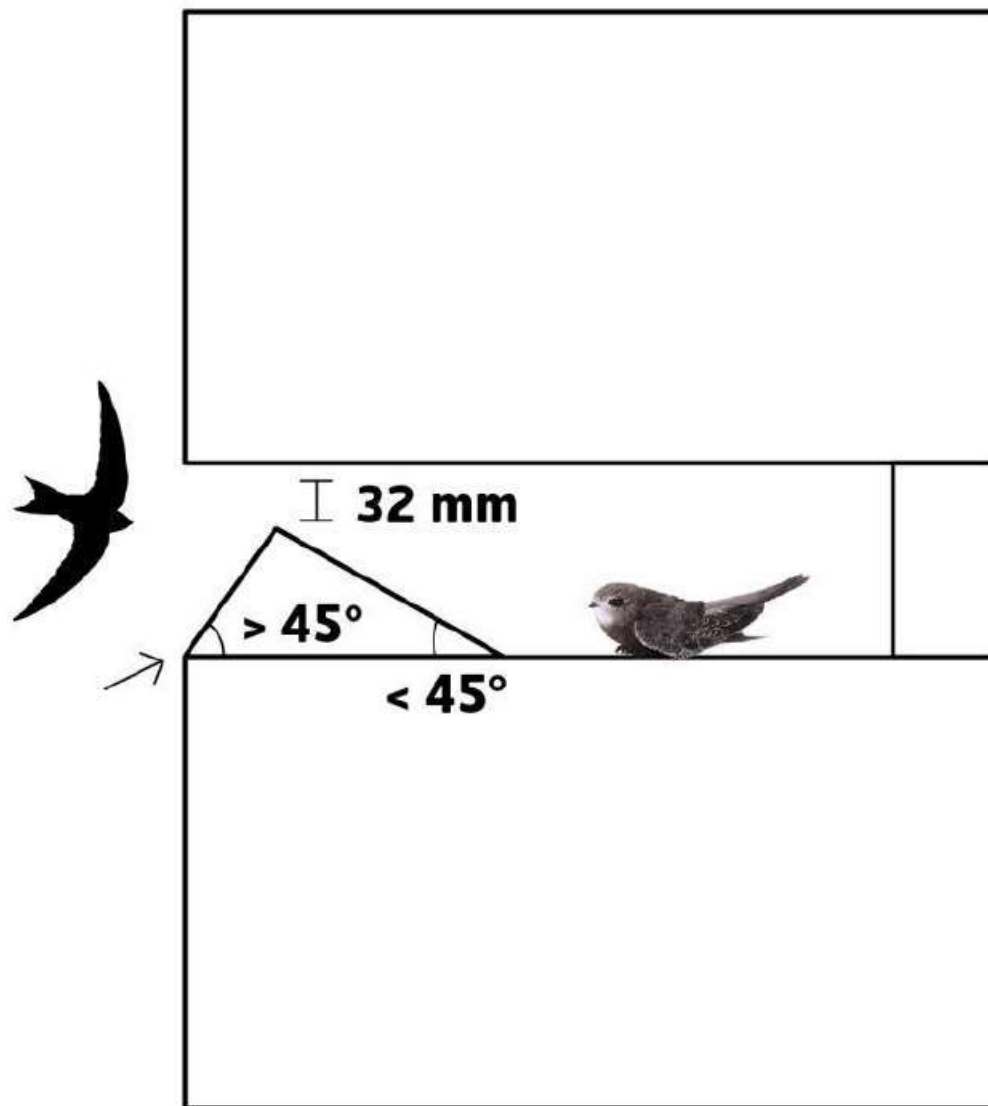

Restauratie 2019 - 2021













Pauscollege



Apuscollege







117 Ferri-stenen

Snel herstel van de kolonie : 30 bezet







Premonstreitcollege KULeuven (12)

College De Valk KULeuven (10)



Zwartzusterklooster KULeuven









Kadoc KULeuven





Maria-Theresiacollege
KULeuven

De makkelijkst
te beschermen
vogel !





STILTEGEBIED





Wim De Bock



Dominique Arnhem



Dominique Arnhem

AVENUE DES

MARTINETS

STEENZWALUWEN

45 ← 1

LAAN



A black bird, possibly a crow or raven, is captured in mid-flight over a paved garden path. The bird's wings are spread wide, showing the intricate structure of its feathers. The background is a lush garden with green bushes and trees, slightly out of focus. The lighting is bright, suggesting a sunny day.

Maar hou
vooral
de gaten !

**Hou ze in
de gaten !**

Thomas Böder